



**DEPARTMENT OF
CAPITAL PROGRAMS**
PRINCE GEORGE'S COUNTY PUBLIC SCHOOLS

COOL SPRING - ADELPHI ELEMENTARY SCHOOL

Project Update Meeting
March 18, 2025



PGCPS





**DEPARTMENT OF
CAPITAL PROGRAMS**
PRINCE GEORGE'S COUNTY PUBLIC SCHOOLS

MEETING LOGISTICS

Servicios De Interpretación

Interpreting Services

On a Computer

At the bottom of the Screen will be an interpretation globe. Click that globe and then select Spanish.

En una Computador

En la parte baja de la pantalla habrá un globo de interpretación. Haga clic en ese globo y seleccione "Spanish."

On a Mobile Device

At the bottom of the screen, tap the ellipses icon on the bottom right (...). Tap "Language Interpretation." Tap "Spanish."

En un Dispositivo Móvil

En la parte baja de la pantalla, toca el icono de ellipses en la parte baja derecha (...). Toque "Language Interpretation." Toque "Spanish."



Questions During the Meeting

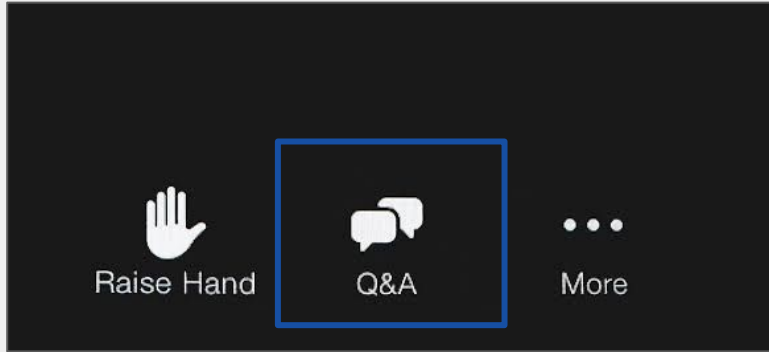

We value your input.

- Please type your questions/comments in the Q&A area of Zoom.
- Questions and answers from this town hall will be posted on the school's project page at bit.ly/DCP-CoolSpring.



Our Commitment

PGCPS is committed to delivering safe, state-of-the-art, and sustainable learning environments for our students, teachers, and communities.

Our Approach

Through the work of our traditional Capital Improvement Program and the nation's first Public School P3 Design-Build-Maintain approach, otherwise known as the Blueprint Schools Program, we're on track to have delivered over 30 new or modernized school facilities within a 15-year span.

AGENDA



**DEPARTMENT OF
CAPITAL PROGRAMS**
PRINCE GEORGE'S COUNTY PUBLIC SCHOOLS



Agenda

01. Team Introductions
02. Project Scope Review
03. Project Timeline
04. Current Status
05. Next Step
06. Q&A



**DEPARTMENT OF
CAPITAL PROGRAMS**

PRINCE GEORGE'S COUNTY PUBLIC SCHOOLS

INTRODUCTIONS

Introductions



Dr. Charoscar Coleman
Chief Operating Officer



Jason Washington
*Associate Superintendent of
Supporting Services*



Shayla Jackson
*Director
Department of Capital Programs*



Dawn Holton
*Senior Mechanical Engineer
Department of Capital Programs*



Will Smith
*Project Management Supervisor
Department of Capital Programs*

Introductions



Scott Adams
Principal
Gilbert Architects



Brianna Blackaby
Project Manager
Gilbert Architects



Doug Ostazeski
Civil Team Leader
Adtek Engineers, Inc.



Joe Howell
Project Manager III
Department of Capital Programs



Dr. Kasandra Lassiter
Associate Superintendent of
Area 1 Schools



Dr. Niki Brown
Instructional Director - Area 1
Schools



Keba Baldwin
Director
Office of Transportation

PROJECT SCOPE



**DEPARTMENT OF
CAPITAL PROGRAMS**
PRINCE GEORGE'S COUNTY PUBLIC SCHOOLS



PHASE 1

- A new energy-efficient, three-story school for 900 students, including the Judy Center, will be built in front of Cool Spring Elementary while the existing school remains open. The project will use modular construction for faster completion and minimal disruption, and it will include upgrades to playgrounds and athletic fields.
- **Cool Spring campus staff and students will remain in the existing building until completion of Phase 1.**
- **Adelphi Elementary staff and students will stay at their current location, the old Cherokee Lane Elementary School building, until Phase 1 is completed.**

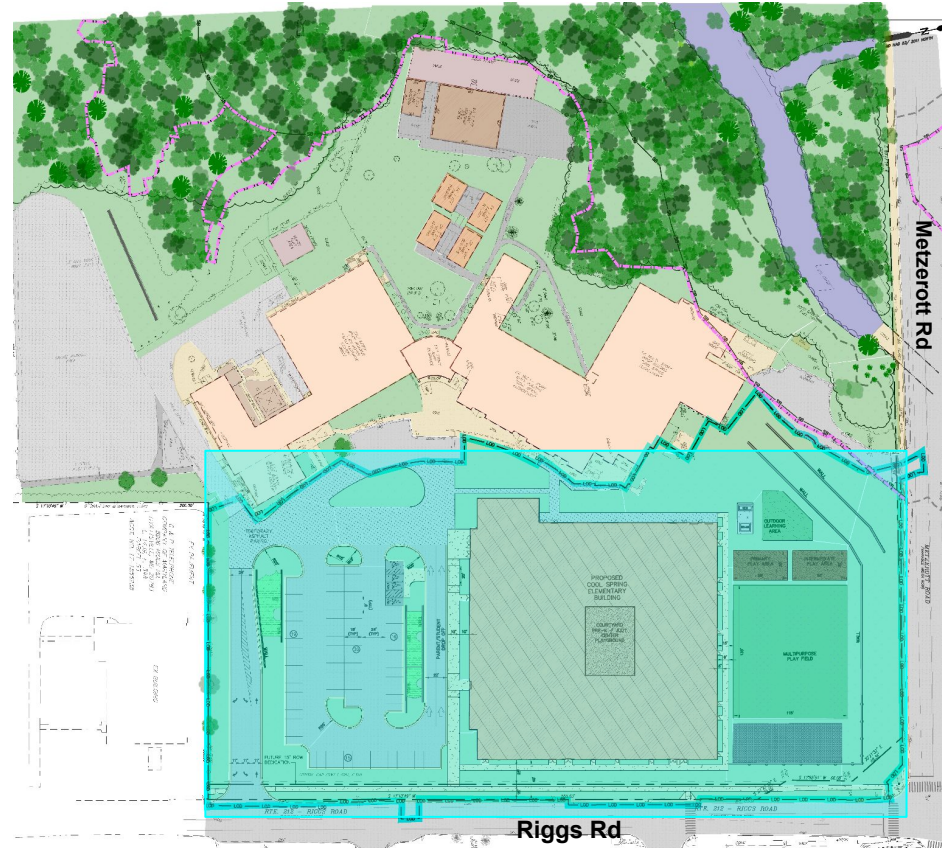

PHASE 2

- Cool Spring Elementary, Adelphi Elementary, and the Judy Center Program will be relocated to the new facility.
- Judy Hoyer Building tenants will move to the existing school building.
- The Judy Hoyer portion of the existing building will be demolished
- A new building will be constructed featuring:
 - Therapy Pool
 - Central Administration Offices, including:
 - English Language Development Program
 - International Student Admission and Enrollment
 - Office of Interpreting and Translation
 - Community-based Family Support Center

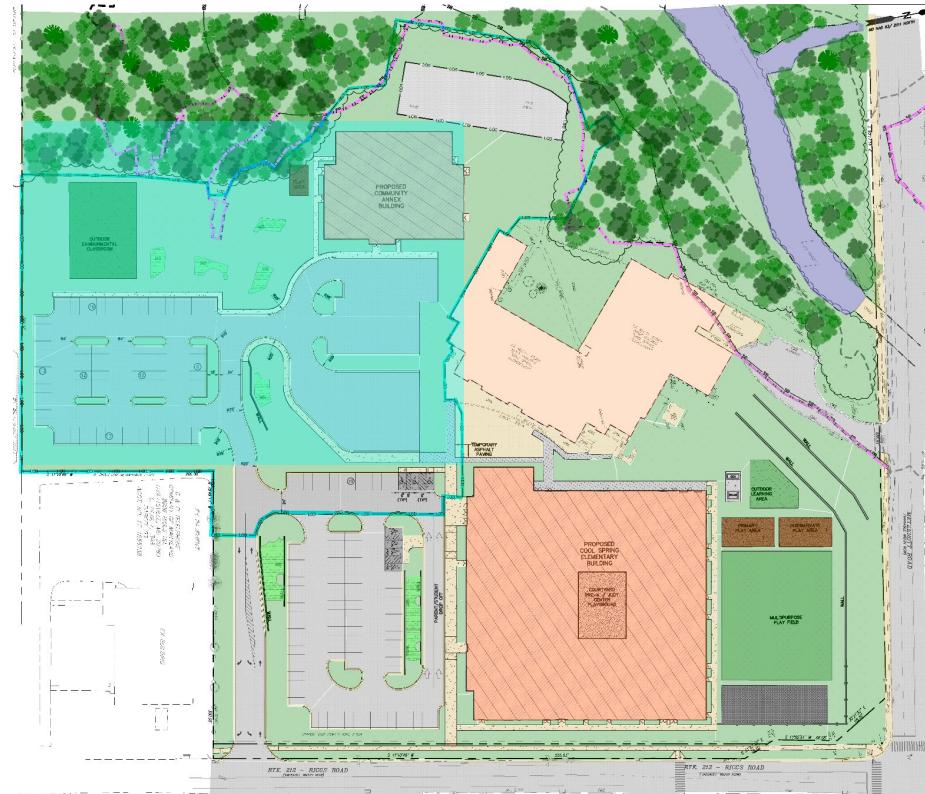

PHASE 3: FINAL SITE WORK

- Judy Hoyer Building Tenants will move to the new Phase 2 building.
- The Mary Center and Office of Psychological Services will move offsite.
- The remaining portion of the existing building will be demolished.
- Final sitework will be completed including site access, additional parking, and the bus loop.

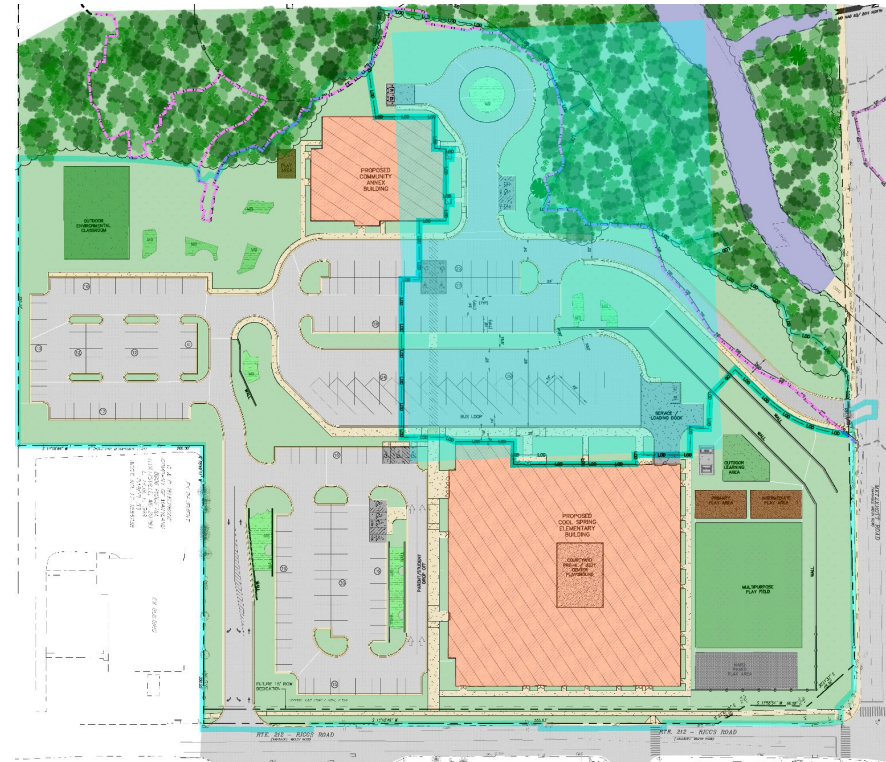

EXTERIOR RENDERINGS



EXISTING SITE PLAN

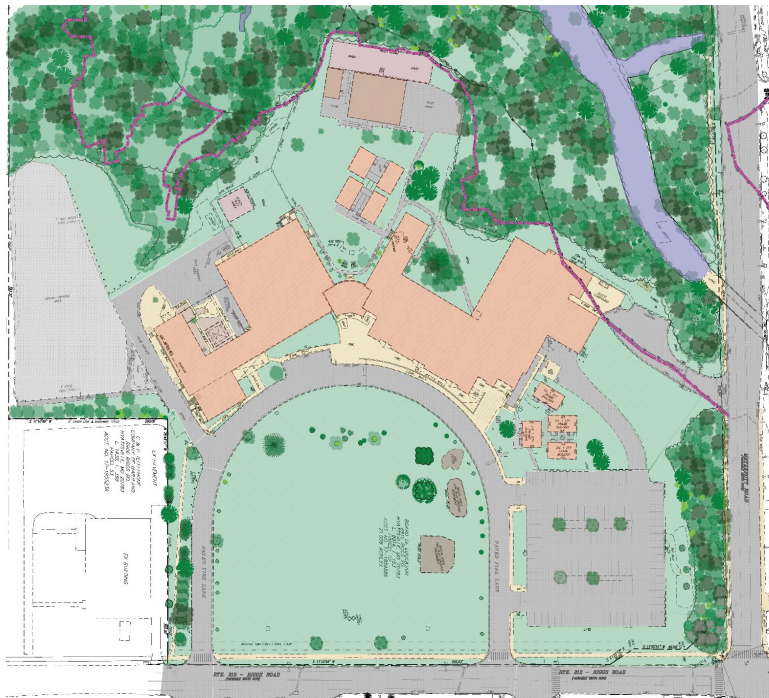

PROPOSED SITE PLAN





**DEPARTMENT OF
CAPITAL PROGRAMS**

PRINCE GEORGE'S COUNTY PUBLIC SCHOOLS

PROJECT TIMELINE

PROJECT TIMELINE

Fall 2023	Feasibility Study and Educational Specification Approved
Fall 2023 - Summer 2025	Design and Permitting
Summer/Fall 2025	Bidding
Fall 2025	Off-site Manufactured Construction (Phase 1)
Winter 2025/2026	On-site Construction (Phase 1)
Summer 2027	Construction Phase 2
August 2027	Occupancy (Completion Phase 1 - New School)
Fall 2028	Occupancy (Completion Phase 2 - Annex Building)
Fall 2028	Construction Phase 3
Spring 2029	Final Completion



**DEPARTMENT OF
CAPITAL PROGRAMS**
PRINCE GEORGE'S COUNTY PUBLIC SCHOOLS

CURRENT STATUS



CURRENT STATUS

Design

- Construction Documents reached 95% completion.
- The site was redesigned to meet updated stream buffer requirements.

Construction Manager

- Proposals from potential construction managers have been submitted and are under review by DCP.
- A decision and award is expected at end of March.

Project Planning Committee

- The Cool Spring-Adelphi Project Planning Committee (PPC) will be formed this month.
- The committee will be chaired by both Principal Carr-Degen and Principal Hill to ensure both school communities are represented.
- The committee's main purpose is review the building design and give input to ensure that the new facility meets the needs of students, staff, and the broader school community.
- The principals have appointed designees to join the committee.



**DEPARTMENT OF
CAPITAL PROGRAMS**
PRINCE GEORGE'S COUNTY PUBLIC SCHOOLS

NEXT STEPS

NEXT STEPS

For the Project

- Phase 1 Design submissions to state and 3rd party code review.
- Finalizing responses to MSDE Educational Specification Review comments for Phase 2 received March 6, 2025. Expected resubmission March 20th or sooner.
- Construction Manager to develop safety plan, traffic plan, onsite construction coordination plans.
- Meetings with PGCPs and school leadership.
- Safety concerns and protocols under consideration by project and school leadership.

For the Communities

- Everyone stays in their respective buildings until the end of Phase 1.
- Community Meetings
 - Fall 2025 Project Update Meeting to discuss the construction phase.
 - Modular Transportation Information Session to discuss off-site construction transportation to site.

QUESTIONS



**DEPARTMENT OF
CAPITAL PROGRAMS**
PRINCE GEORGE'S COUNTY PUBLIC SCHOOLS



Question & Answer

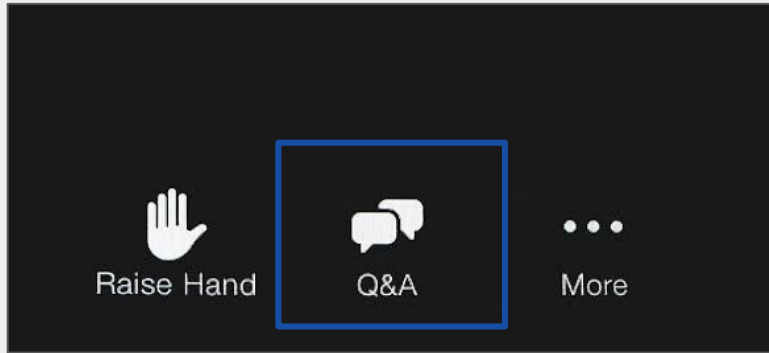

- Please type your questions/comments in the Q&A area of Zoom.
- Questions and answers from this town hall will be posted on the Cool Spring project page at bit.ly/DCP-CoolSpring.
- If you have additional questions, please email them to capital.programs@pgcps.org.

Cool Spring Annex-Judy Hoyer



Status Design	Funding Model Budget Generation	Project Type Feasibility	Budget \$5,000,000	Architect D. Scott & Associates	Source of Contractor T&E	Project Manager James Vance
------------------	------------------------------------	-----------------------------	-----------------------	--	-----------------------------	--

School Information

Midland Lancaster College	Address 8710 Kipp Road, Dallas, TX 75238	Neighborhood Galleria	School District Dallas ISD	County Council District District 3	State Legislative District District 27
------------------------------	---	--------------------------	-------------------------------	---------------------------------------	---

Project Timeline



Project Scope

Dedication of a new school in form of the existing East Spring Elementary School will be the existing school in question. The proposed school, including the Judy Center is anticipated to be three floors and accommodate K-12 students. The new school will be built to be energy efficient and meet all current building and accessibility codes.

(Pharmaceuticals affect the school; portion of the existing building will be demolished and a new building will be constructed consisting of a Therapy Pool, General Gymnasium, music room, library, computer laboratory, kitchen and Theater. Services are provided on a community basis through the Family Support Center.

During the Phase 1 access all mail to, from and to the old server including all its elements will be migrated including its users and profile improvements.

News & Announcements

There are currently no arrangements in place for this program.

Project Updates

January 2023	0
August 2024	0
June 2024	0
April 2024	0
February 2024	0
November 2023	0

Documents & Presentations

Project Update Meeting - 14/04/2014 / [Viewing Presentation \(English, German, French, 2014\)](#) / [Viewing Presentation \(English, German, French, 2014\)](#)

Project Information: Term: Fall • 10.08.2023 | [Findings Presentation: English, German, French 2024](#) | [English, German, French](#)

Questions and answers from this town hall will be posted on the Cool Spring project page at bit.ly/DCP-CoolSpring.

THANK YOU

Contact Us

capital.programs@pgcps.org

